

# LBAC's Family Calendar & Events

## Sunday, October 29

9:00AM Morning Coffee  
 9:30AM Worship & Celebration Service  
 11:15AM Foundations Hour Session #2  
 11:15AM Christmas Musical Rehearsal  
 12:15AM Deacon Meeting

## Monday, October 30

6:00PM Compulsive Eaters Anonymous

## Wednesday, November 1

6:30PM AWANA

## Thursday, November 2

7:00PM Junior High Youth Group

## Friday, November 3

6:30AM Men's Bible Study  
 8:00PM Narcotics Anonymous

## Saturday, November 4

8:00AM Men's Breakfast  
 9:00AM Compulsive Eaters Anonymous

## Sunday, November 5

9:00AM Morning Coffee  
 9:30AM Worship & Celebration Service  
 11:15AM Foundations Hour Session #2  
 11:15AM Christmas Musical Rehearsal

### MISSIONS

<http://www.lbac.org/missions>

### GROWTH GROUPS

<http://www.lbac.org/gg>

Mid-week Bible Studies for all Adults

### CHILDREN'S MINISTRIES

<http://www.lbac.org/children>

### Sunday Mornings

Gospel Project @ 9:30AM

Fun-N-Funky Hour @ 11:15AM

### AWANA

<http://www.lbac.org/awana>

Wednesdays through May 6:30PM-8:30PM

### YOUTH MINISTRIES

<http://www.lbac.org/youth>

JH & HS Foundations ~ Sundays @ 11:15AM

HS Core Groups ~ Tuesdays @ 7:00PM

JH Core Groups ~ Thursdays @ 7:00PM

### WOMEN'S MINISTRIES

<http://www.lbac.org/women>

### Woman To Woman Mentoring

Contact: sherylynnlbac@gmail.com

### Lydia House Meals Ministry

Contact: robbi@apabrando.com

### Women Connecting with Missions

3<sup>rd</sup> Tuesday of each month @ 7:00PM

### Crafty Women

2<sup>nd</sup> Saturday of each month @ 10:00AM

### MEN'S MINISTRIES

<http://www.lbac.org/men>

Contact: mensministry@lbac.org

## long beach alliance church offices

3331 palo verde avenue · long beach, ca · 90808-4113  
 phone: 562.420.1478 · office@lbac.org · www.lbac.org  
 www.facebook.com/longbeachalliancechurch  
 church office hours: tuesday-thursday, 10:00AM-5:00PM

### church staff team

michelle crammer, office manager  
 maternity leave

kelly douglas, international worker  
 kelly@lbac.org

jesse duckett, youth pastor  
 ext. 1005 · jesse@lbac.org

chris lankford, lead pastor  
 ext. 1001 · chris@lbac.org

tina rand, receptionist & treasurer  
 exts. 1000 & 1006 · tina@lbac.org

ben shaw, worship & celebration intern  
 ben@lbac.org

matt swaney, family ministry pastor  
 ext. 1003 · matt@lbac.org

scott trickett, associate pastor  
 ext. 1002 · scott@lbac.org

Weekly Schedule

Regular Ministry Schedule & Contacts



THE ALLIANCE

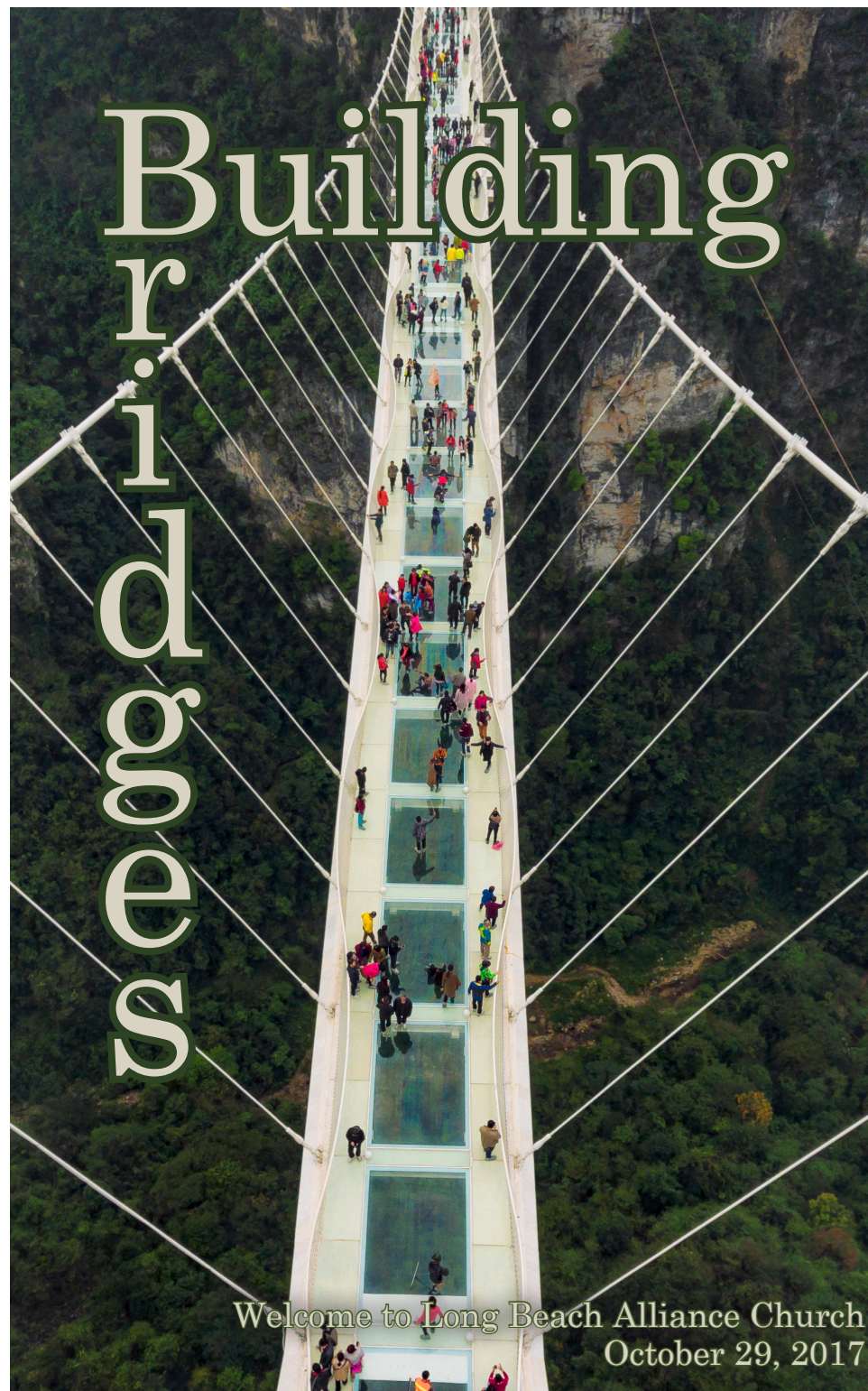



welcome to long beach alliance church  
a community of Jesus followers who  
love God, love others, & serve the world

**FOUNDATIONS**

Session #2 begins today!

• **Reformation: Why We Became Protestants**

John Carriveau, Downstairs- Room #102

"So, I'm a Protestant; what does that mean?"

The Reasons for the Reformer's Passion and Sacrifices

• **Developing Gospel-Centered Friendships**

Chris Lankford, Upstairs- Room #203

Friendship=Trust=Gospel Living=Gospel Friendships=You

• **Griefshare**

Meghan Brearley, Downstairs- Room#106

Walking alongside each other through one of life's most difficult experiences.

• **NO FUN N FUNKY HOUR THIS SESSION**

Jesus Means Christmas to Me  
Christmas Musical  
Kindergarten-Grade 8  
Foundations Hour, 11:15AM-12:15PM  
Sanctuary  
Marikka Ostermann/Jill Shaw

**MEN'S FELLOWSHIP BREAKFAST**  
long beach alliance  
Saturday, November 4  
at 8:00AM

**OPERATION Christmas Child**  
Samaritan's Purse  
**Pack a Shoebox**  
Pick up boxes TODAY!  
November 5-12: Drop off

**LBAC Year-to-Date Financial Report**

Budget	Required	Received	Budget %
Weekly:	\$12,041.97	\$14,327.53	119.0%
Month-to-Date:	\$48,167.88	\$48,893.68	101.5%
Year-to-Date:	\$96,335.76	\$87,977.04	91.3%
Disbursed YTD:	\$80,849.00	GOF Balance:	\$7,128.04

# sunday morning schedule & room assignments for sunday mornings • fall/winter, 2017

## sunday morning guide

**9:30AM • adult worship**  
**kids gospel project**

birth-2 years - rooms 103 & 104  
 3 & 4 year olds - room 105  
 kgn. & 1st grade - room 206  
 2nd & 3rd grades - room 205  
 4th & 5th grades - room 202  
 jr. highs-all adults - worship center

**11:15AM • adult foundations hour**  
**kids musical (K-8<sup>th</sup> grade)**

birth-2 years - rooms 103 & 104  
 3 & 4's - kgn. - room 105  
 K - 8<sup>th</sup> grades - kids musical in sanctuary  
 junior & senior high - room 202  
 reformation • 500 adult class - room #102  
 griefshare adult class - room #106  
 gospel-centered friendship adult class - room #203

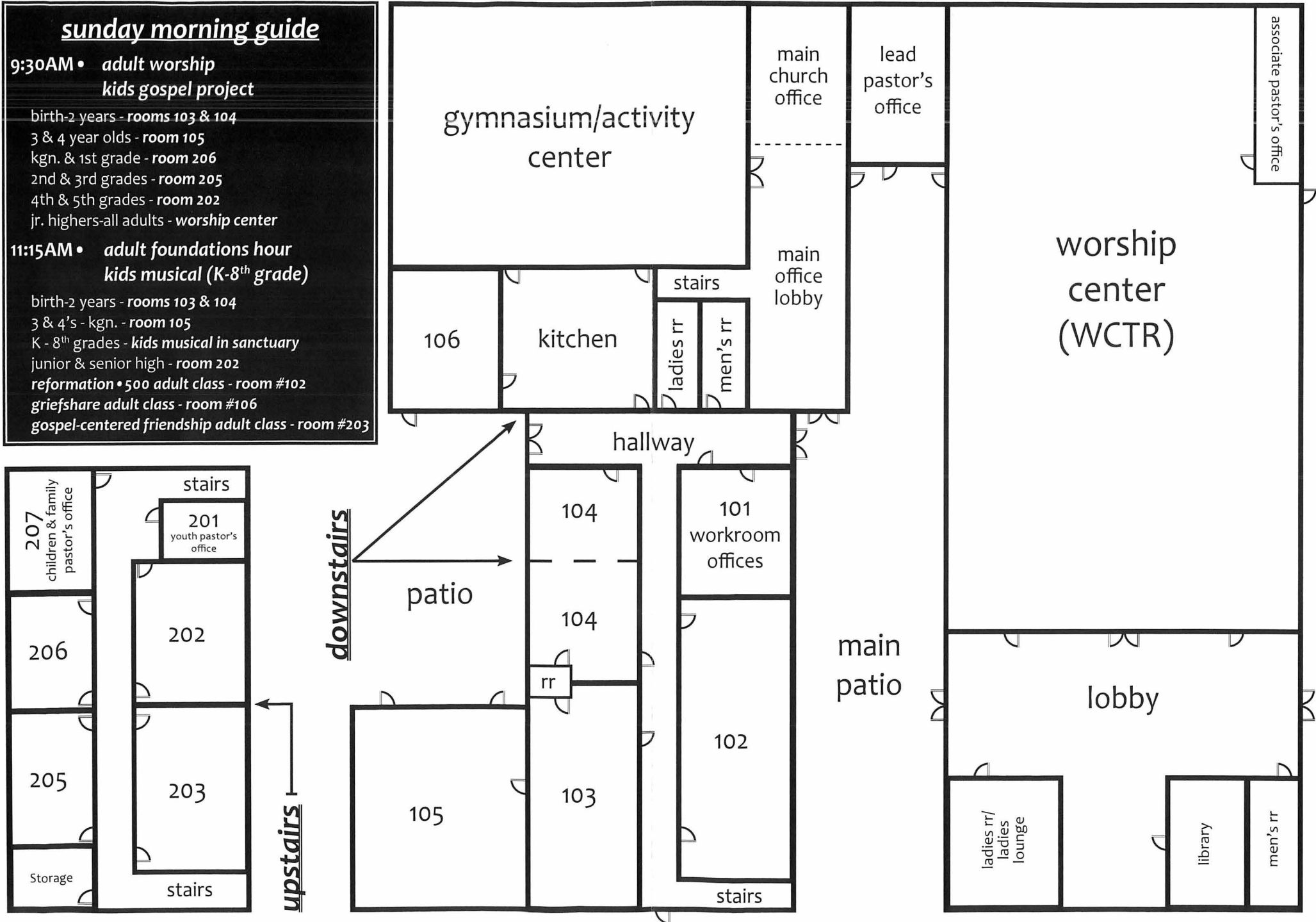

# Smart Farmers

Luke 8:1-15

Long Beach Alliance Church • October 29, 2017 • Pastor Chris Lankeford

## 1) The Importance of Women in Ministry

- Luke 8:1-3 (also note 7:11-17 & 7:36-50)

Women Serving In \_\_\_\_\_ Ministry Are \_\_\_\_\_ For The \_\_\_\_\_

## 2) Family Stories Reveal Family Secrets

- Luke 8:9-10, Isaiah 6:9-10

How You \_\_\_\_\_ to Jesus' Parables Identifies Spiritual \_\_\_\_\_ or \_\_\_\_\_

## 3) Smart Farmers Cultivate Great Environments

- Luke 8:5-8, 11-15

The Different \_\_\_\_\_ Represent Varied \_\_\_\_\_ for Gospel Growth

The Farmer Must Have \_\_\_\_\_ In The \_\_\_\_\_ of The Seed He Plants

Farmers Work Very Hard To \_\_\_\_\_ For Growth



- What was your favorite children's story, either as a kid, or to read to your kid(s)? Why?
  - *Read Luke 8:1-15*
  - *Discuss what you learned from this week's sermon.*
1. Luke 8:4,9-10. This is the first major parable in Luke's gospel. What are parables and what distinguishes them from other teachings?
    - 1A. Read Matthew 13:10-15. Why does Jesus speak in parables?
    - 1B. If you can, list 10 parables from memory. Which is your favorite?

2. Luke 8:10 speaks of the kingdom of God. Also read Mark 1:14-15, Mark 9:1, Luke 1:33, Luke 17:20-21, John 3:3-5, John 18:36, Revelation 12:10. What is the kingdom of God? Is it here now or yet to come?

3. Luke 8:11-15. What do each of the four soils represent? Give examples from life today.  
Path:

Rock:

Thorns:

Good soil:

3A. What is the overall message of this parable?

## Making It Relevant

1. Which soil best represents you? Are you seeing the spiritual fruit in your life indicating good soil?
2. What can you do to cultivate better “soil” in your life?
3. Do you know someone who is like the rocky or thorny soil? How can you help them to get rid of the rocks and thorns?